

PARALLEL BARREL DRIFT
MATERIAL SPECIFICATION-IS:1875; CLASS- IV

TYPE	NOMINAL DIA. OF RIVETS (MM)	Ø D (MM)	DIMENSION OF DRIFT				GRIP (MM)	NOS. REQUIRED
			A (MM)	B (MM)	ØC(MM)	L (MM)		
1	20	21.5	32	58	11	122	32 TO 36	317
2	20	21.5	32	74	11	138	42 TO 52	672
3	20	21.5	32	98	11	162	68 TO 76	499
							TOTAL QTY.=	1488

NOTE:-

- ALL DIMENSIONS ARE IN mm.
- THESE DRIFT NOS. ARE BASED ON 15% OF HSFG BOLTSS./SPAN

BHARAT BHARI UDYOG NIGAM LIMITED
 (AS PER GOVT. ORDER BBJ AMALGAMATED WITH BUNL W.E.F 10/07/2015)

CLIENT:

NORTHERN RAILWAY

PROJECT: CONSTRUCTION OF 4 LANE R.O.B.(1x21.6+1x25.08+1x21.6M.)
 SPAN COMPOSIT GIRDER IN LIEU OF LEVEL CROSSING NO.-
 7-B/T-2 AT LUCKNOW-ZAFRABAD SECTION NEAR JAUNPUR

TITLE:

**REQUIREMENT OF DRIFT
 FOR ERECTION 1 x 24.0 M. SPAN GIRDER**

SCALE:- 1:10

NAME

DATE

B.B.J. ORDER NO.- 3123

DRAWN BY:

R. BOSE

28.09.15

DRG. NO.

REV.

CHECKED BY:

3123-SK-01

APPROVED BY:

SHEET:

A4

REQN. NO:-
 D/561

DATE :-
 28.09.15

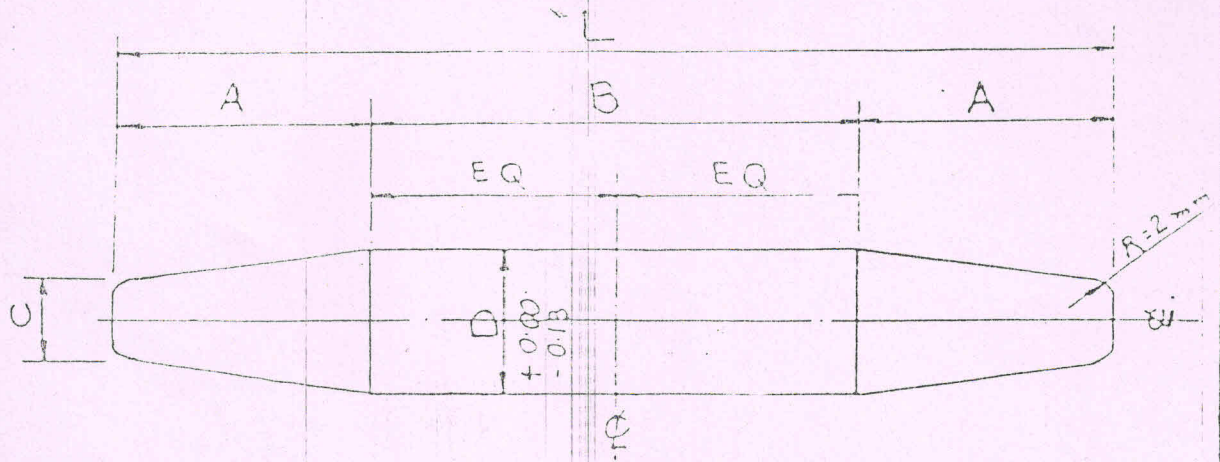

PARALLEL BARREL DRIFT
TO GRADE: IRS M4 CLASS IV

TYPE	DIA D	DIMENSION OF DRIFT				GRIP	NOS. REQD.
		A	B	C	L		
1.	23.5	35	55	12	125	19 TO 30	200
2.	21.5	30	50	11	110	16 TO 26	200
3.	17.5	25	55	10	110	19 TO 30	50

NOTES :-

1. ALL DIMENSIONS ARE IN MILLIMETRE
2. DRIFT NOS. ARE BASED ON 30% OF NETT SITE RIVET NOS

J. Bhawal
19.03.2007

Req^d No - D/312 DT. 20.03.2007

61.0^M SPAN WELDED GIRDER OVER
JAJPUR KEONJHAR ROAD FLYOVER
EAST COAST RAILWAY

REQUIREMENT OF DRIFT

B.B.J. SKETCH NO.-3100/SK-3